

Discharge bore mm	Phases	Motor output kW	Head max. m	Capacity max. l/min	Max. solid handling ø mm	PH value
3" BSPT	1	0,75	10,8	580	7	5.0-9.0



GENERAL

ø Discharge bore mm	80
Discharge Connection	Threaded flange/Hose coupling

PUMP

COMPONENTS

Impeller	Semi-Vortex impeller
Shaft Seal	Double mechanical seal
Bearings	Shielded ball bearings

MATERIAL

Impeller	Urethane rubber
Casing	Ductile iron casting EN-GJS-700-2
Shaft Seal	Silicon carbide in oil bath

PUMPING FLUID

Type of Fluid	Spring water, Rain water, Ground water, Sand carrying water
Temperature	0-40°C

MOTOR

Type, Poles	Induction motor, 2 poles, IP68
Insulation	Insulation class E
Phase / Voltage	Single phase 230V / 110V / 50Hz
Motor Protector (built-in)	Miniature protector
Lubrication	Turbine oil (ISO VG32)

MATERIAL

Casing	Aluminium die casting
Shaft	Stainless steel EN-X6Cr13
Cable	Rubber, 10m H07RN8-F

HS3.75SL

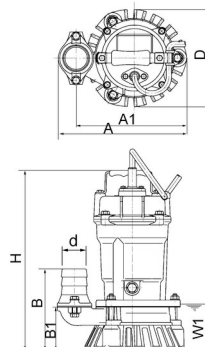

Model	d	A	A1	B	B1	D	H	W1
HS3.75SL	80	317	233	217	141	184	454	120

In the event of abrasive and corrosive utilization, stronger wear and tear will take place naturally in certain components. In this regard, please pay attention to our website www.tsurumi.eu/english/applications.htm.

Updated 06/2024