

Discharge bore mm	Phases	Motor output kW	Head max. m	Capacity max. l/min	Max. solid handling ø mm	ATEX available	Dry installation	PH value
300	3	132	38,0	32500	150	Yes	-	5.0-9.0



GENERAL

ø Discharge bore mm	300mm
Discharge Connection	Flange DIN/ANSI DN300 (PN10)
Optional Accessories	Guide rail fitting "TOS" (guide support, duck foot bend, lifting chain) / Bend and stand set for free standing types
Oil chamber	Moisture Sensor Cooling Jacket

PUMP

COMPONENTS

Impeller	Dual channel impeller
Shaft Seal	Double mechanical seal
Bearings	Shielded ball bearings

MATERIAL

Impeller	Grey iron casting EN-GJL-250
Casing	Grey iron casting EN-GJL-250
Shaft Seal	SiC, upper in oil bath
Wearing	Bronze

PUMPING FLUID

Temperature	0-40°C
Type of Fluid	Municipal sewage

MOTOR

Lubrication	Turbine oil (ISO VG32)
Motor Protector (built-in)	Miniature protector
Type, Poles	Induction motor, 6 poles, IP68
Insulation	Insulation class H
Phase / Voltage	3-phase / 400V / 50Hz / s.d.

MATERIAL

Casing	Grey iron casting EN-GJL-250
Shaft	Stainless steel EN-X20Cr13
Cable	Rubber, 10m H07RN8-F

300BYM6132

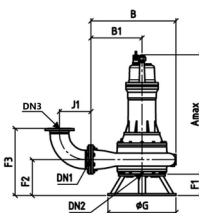
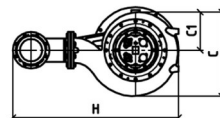

Model	A	B	B1	C	C1	DN1	DN2	DN3
300BYM6132	2090	1220	700	1022	443	300	350	300

Please mind: discharge bend, duck foot bend and stand set are accessories and must be ordered separately