

Model	Discharge bore mm	Phases	Motor output kW	Head max. m	Capacity max. l/min	Max. solid handling ø mm	ATEX available	Dry installation
100BYM42.6L	100	3	2,6	11,1	1833	80	Yes	-



GENERAL

ø Discharge bore mm	100mm, 150mm, 200mm, 300mm
Discharge Connection	Flange DIN/ANSI DN100 (PN10), Flange DIN/ANSI DN150 (PN10), Flange DIN/ANSI DN200 (PN10), Flange DIN/ANSI DN300 (PN10)
Optional Accessories	Guide rail fitting "TOS" (guide support, duck foot bend, lifting chain) / Bend and stand set for free standing types
Oil chamber	Moisture Sensor

PUMP

COMPONENTS

Impeller	Single channel impeller, Dual channel impeller
Shaft Seal	Double mechanical seal
Bearings	Shielded ball bearings

MATERIAL

Impeller	Grey iron casting EN-GJL-250
Casing	Grey iron casting EN-GJL-250
Shaft Seal	SiC, upper in oil bath
Wearing	Bronze

PUMPING FLUID

Temperature	0-40°C
Type of Fluid	Municipal sewage

MOTOR

Lubrication	Turbine oil (ISO VG32)
Motor Protector (built-in)	Miniature protector
Type, Poles	Induction motor, 4 poles, IP68, Induction motor, 6 poles, IP68
Insulation	Insulation class H
Phase / Voltage	3-phase / 400V / 50Hz / d.o.l., 3-phase / 400V / 50Hz / s.d.

MATERIAL

Casing	Grey iron casting EN-GJL-250
Shaft	Stainless steel EN-X14Cr-Mo-S17, Stainless steel EN-X20Cr13
Cable	Rubber, 10m H07RN8-F

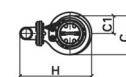

100BYM42.6L

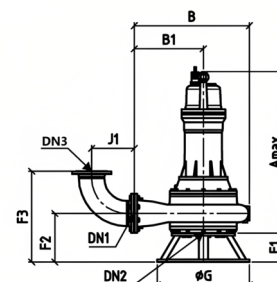

Model	A	B	B1	C	C1	DN1	DN2	DN3	F1	F2	F3	G	H	J1
100BYM42.6L	554	360	200	305	145	100	100	100	125	218	403	395	577	122

Please mind: discharge bend, duck foot bend and stand set are accessories and must be ordered separately