

LH430W

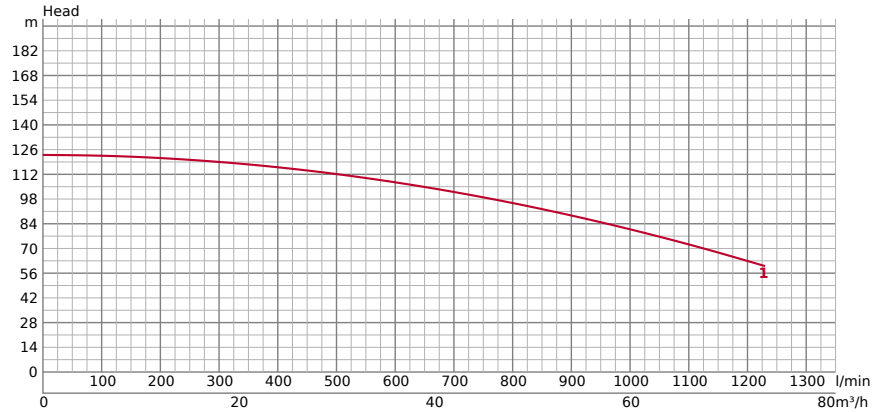

TECHNICAL INFORMATION

GENERAL		PUMPING FLUID	
Ø Discharge bore mm	100	Type of Fluid	Drainage
Discharge Connection	JIS 20K Flange	Temperature	0-40°C
		Max. Solid Handling mm	8.50
		Max. dry matter %	3-5
		Max. PH Value	5-9
		Max. Capacity l/min	1230
		Max. Head m	123

PUMP	COMPONENTS	MATERIAL	
	Impeller	Closed type impeller	Impeller
	Bearings	Shielded ball bearings	Chromium iron casting
	Mechanical Seal	Dual mechanical seal in oil bath	Casing
			Grey iron casting EN-GJL-200
			Suction Plate
			Chromium iron casting
			Pump Body
			Carbon Steel
			Mechanical Seal
			Silicon Carbide

TECHNICAL INFORMATION | Motor, Others on the next page →

MOTOR	Motor output kW	30,0	MATERIAL	
	Starting method	star/delta	Frame	Grey iron casting EN-GJL-200
	Suitable for VFD	Yes	Shaft	Stainless steel EN-X30Cr13
	Suitable for Soft Starter	Yes	Cable	NSSHÖU 7C*35mm ² /2C*2. 5mm ²
	Type, Poles	Induction motor, 2 poles, IP68	Cable Length	20m
	Insulation	Insulation class F		
	Phase / Voltage	3-phase / 400V / 50Hz		
	r.p.m.	2900		
	Motor Protector (built-in)	Circle thermal cut-out		
	Rated Current	53		
	Voltage Change 400V --> 230V	Re-Winding		
	Voltage Change 400V --> 690V	External connection (star)		

OTHERS	Dry Weight Kg	324
	Pressure Resistance	max. 50m

DIMENSIONS

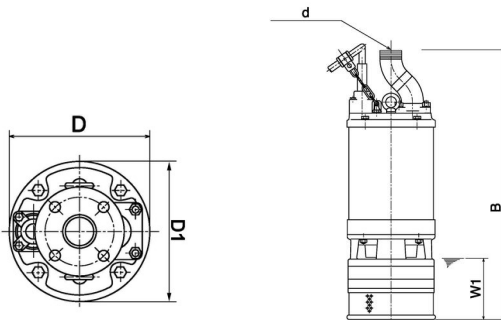
DIMENSIONS - IN MM

B	1375	d	100	W1	300
D	330				

PERFORMANCE CURVE

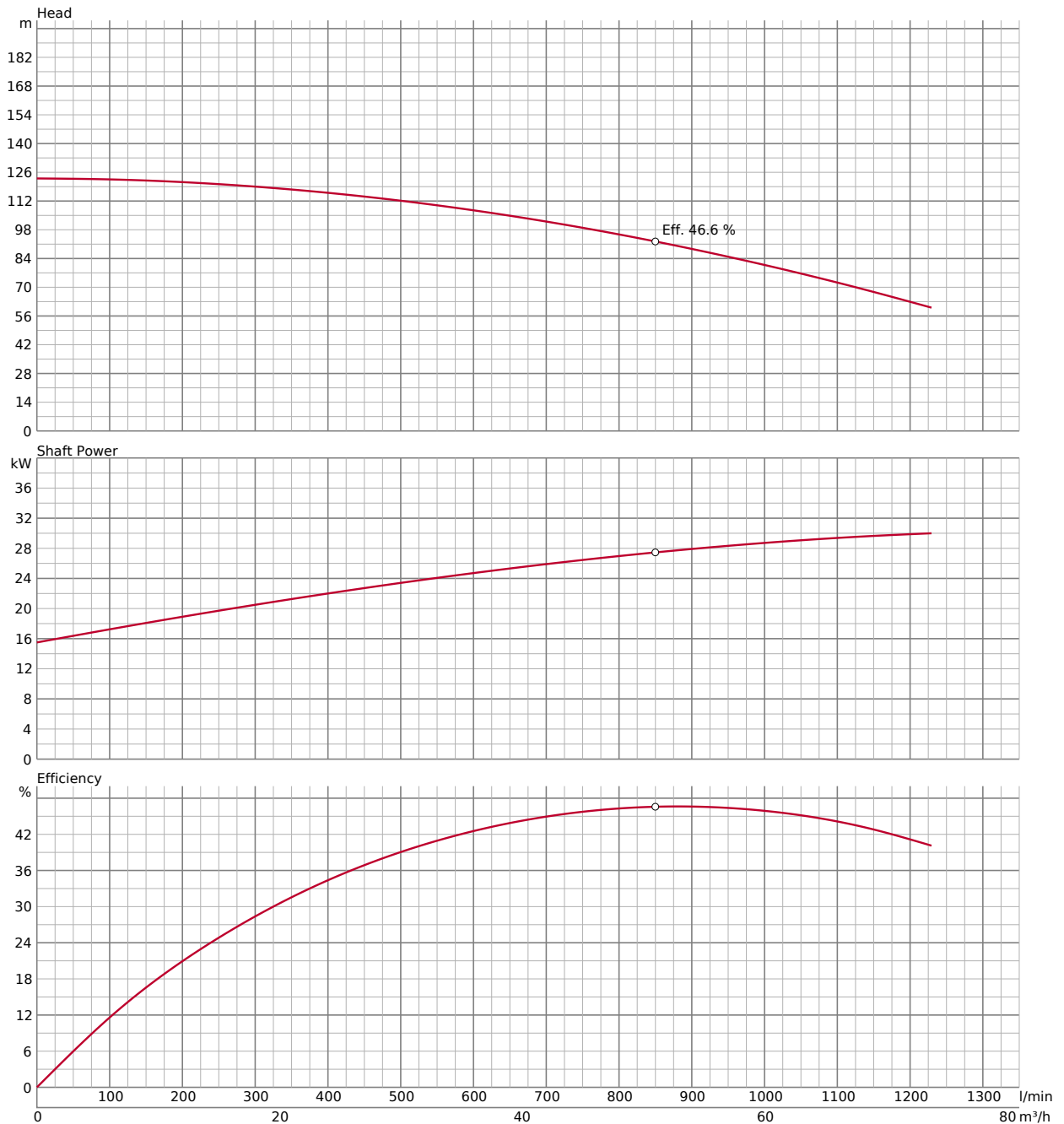

In the event of abrasive and corrosive utilization, stronger wear and tear will take place naturally in certain components. In this regard, please pay attention to our website www.tsurumi.eu/english/applications.htm.

ACCESSORIES

FLANGE ADAPTERS **048-TEG-02**

Flange Adapter JIS/DIN

SPECIFICATIONS

No. Of bolt holes	8
-------------------	---

Flange adapter for 4" JIS 20K - 4" DIN PN16



OIL LEAKAGE SENSOR **TSS-TEG-10**

TSS Seal Oil Sensor M10 (10m)

Externally mounted leak sensors for water detection inside of oil chamber. Please note, an additional relay e.g. finder needs to be installed.

