

Discharge bore mm	Phases	Motor output kW	Head max. m	Capacity max. l/min	Max. solid handling ø mm	PH value
50	3	0,4	4,9	180	16	5.0-9.0



GENERAL

ø Discharge bore mm	50mm
Discharge Connection	Hose coupling

PUMP

COMPONENTS

Impeller	Non-clog impeller
Shaft Seal	Double mechanical seal
Bearings	Shielded ball bearings

MATERIAL

Impeller	Grey iron casting EN-GJL-200
Upper casing	Grey iron casting EN-GJL-200
Lower casing	Grey iron casting EN-GJL-200
Shaft Seal	Silicon carbide in oil bath
Float	Plastic

PUMPING FLUID

Temperature	0-40°C
Type of Fluid	Treated sewage

MOTOR

Lubrication	Turbine oil (ISO VG32)
Motor Protector (built-in)	Circle thermal cut-out
Type, Poles	Induction motor, 2 poles, IP68
Insulation	Insulation class E
Phase / Voltage	3-phase / 400V / 50Hz / d.o.l.

MATERIAL

Casing	Grey iron casting EN-GJL-150
Shaft	Stainless steel EN-X6Cr13
Cable	Rubber, NSSHÖU

4-FSP

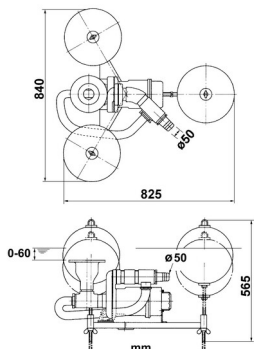

Please mind: discharge bend, duck foot bend and stand set are accessories and must be ordered separately