

| | | | | | | |
|-------------------|--------|-----------------|-------------|---------------------|--------------------------|----------|
| Discharge bore mm | Phases | Motor output kW | Head max. m | Capacity max. l/min | Max. solid handling ø mm | PH value |
| 2" BSPT | 1 | 0,4 | 12,2 | 207 | 7 | 5.0-9.0 |



GENERAL

| | |
|----------------------|-------------------------------|
| ø Discharge bore mm | 50 |
| Discharge Connection | Threaded flange/Hose coupling |

PUMP

COMPONENTS

| | |
|------------|------------------------|
| Impeller | Semi-Vortex impeller |
| Shaft Seal | Double mechanical seal |
| Bearings | Shielded ball bearings |

MATERIAL

| | |
|------------|--------------------------------------|
| Impeller | Urethane rubber |
| Casing | Ductile iron casting EN-GJS-700-2 |
| Shaft Seal | Silicon carbide in oil bath |

PUMPING FLUID

| | |
|---------------|---|
| Type of Fluid | Spring water, Rain water, Ground water, Sand carrying water |
| Temperature | 0-40°C |

MOTOR

| | |
|----------------------------|---------------------------------|
| Type, Poles | Induction motor, 2 poles, IP68 |
| Insulation | Insulation class E |
| Phase / Voltage | Single phase 230V / 110V / 50Hz |
| Motor Protector (built-in) | Miniature protector |
| Lubrication | Turbine oil (ISO VG32) |

MATERIAL

| | |
|--------|---------------------------|
| Casing | Aluminium die casting |
| Shaft | Stainless steel EN-X6Cr13 |
| Cable | Rubber, 10m H07RN8-F |

HS2.4S

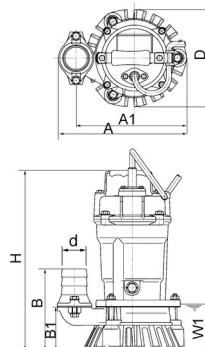

| Model | d | A | A1 | B | B1 | D | H | W1 |
|--------|----|-----|-----|-----|----|-----|-----|----|
| HS2.4S | 50 | 240 | 207 | 158 | 84 | 185 | 358 | 90 |

In the event of abrasive and corrosive utilization, stronger wear and tear will take place naturally in certain components. In this regard, please pay attention to our website www.tsurumi.eu/english/applications.htm.

Updated 06/2024